

# AV 23 SETTER Bypass SD

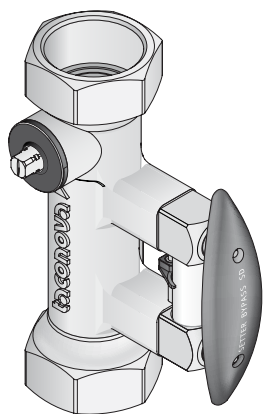

| DN | Rp x Rp         | L (mm) |    |
|----|-----------------|--------|----|
| 15 | 1/2" x 1/2"     | 142    | 7  |
| 20 | 3/4" x 3/4"     | 129    | 7  |
| 25 | 1" x 1"         | 152    | 8  |
| 32 | 1 1/4" x 1 1/4" | 161    | 8  |
| 40 | 1 1/2" x 1 1/2" | 173    | 12 |
| 50 | 2" x 2"         | 197    | 12 |

|    |        |  |
|----|--------|--|
| TB | 100°C  |  |
| PB | 10 bar |  |



a1

a2

a3

m1

m2

m3

m4

m5

- 223.2262.000 ☒ DN15
- 223.2360.000 ☒ DN20
- 223.2362.000 ☒ DN20
- 223.2460.000 ☒ DN25
- 223.2461.000 ☒ DN25
- 223.2561.000 ☒ DN32
- 223.2661.000 ☒ DN40
- 223.2861.000 ☒ DN50

r1

r2

r3

r4

r5

Změna vyhrazena.

07/07 208456 - EA 1057